

# Main Hospital

## Basement Floor



**B**  
BASEMENT

**Legend**

- ▶ Entrance
- ⊠ Elevators
- ☐ Stairs
- ♿ Restrooms

 Smoking is not permitted on Bayhealth grounds.

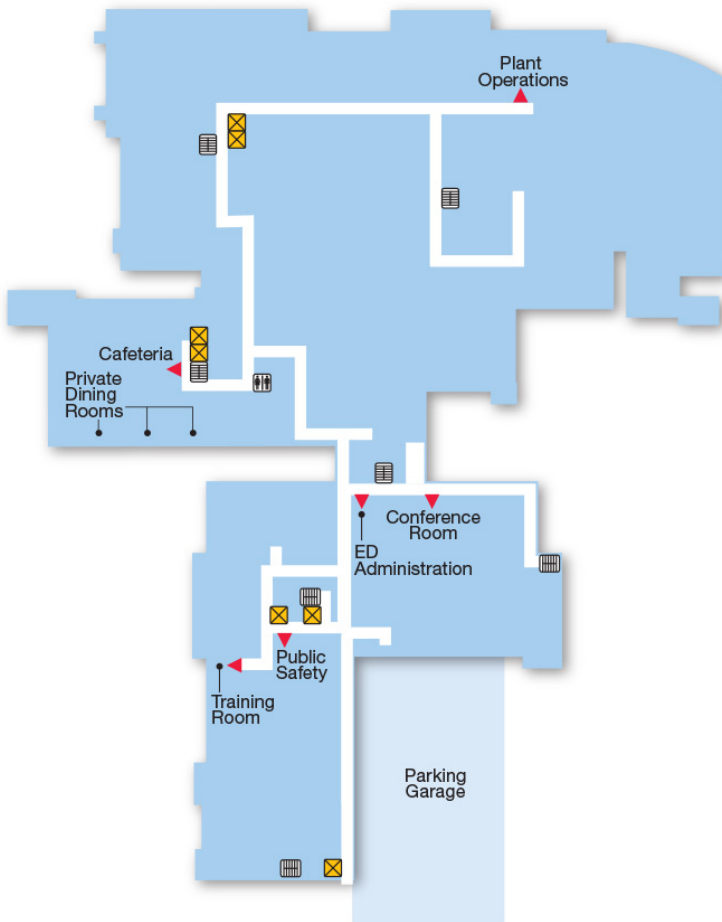

# First Floor



**1st**  
FLOOR

## Legend

- Entrance
- Elevators
- Stairs
- Information
- Waiting Area
- Restricted Access
- Restrooms
- Nurses Station
- Vending
- ATM
- Security Desk



# Second Floor



2nd  
FLOOR

Legend

- Entrance
- Elevators
- Stairs
- Waiting Area
- Restricted Access
- Restrooms

 Smoking is not permitted on Bayhealth grounds.

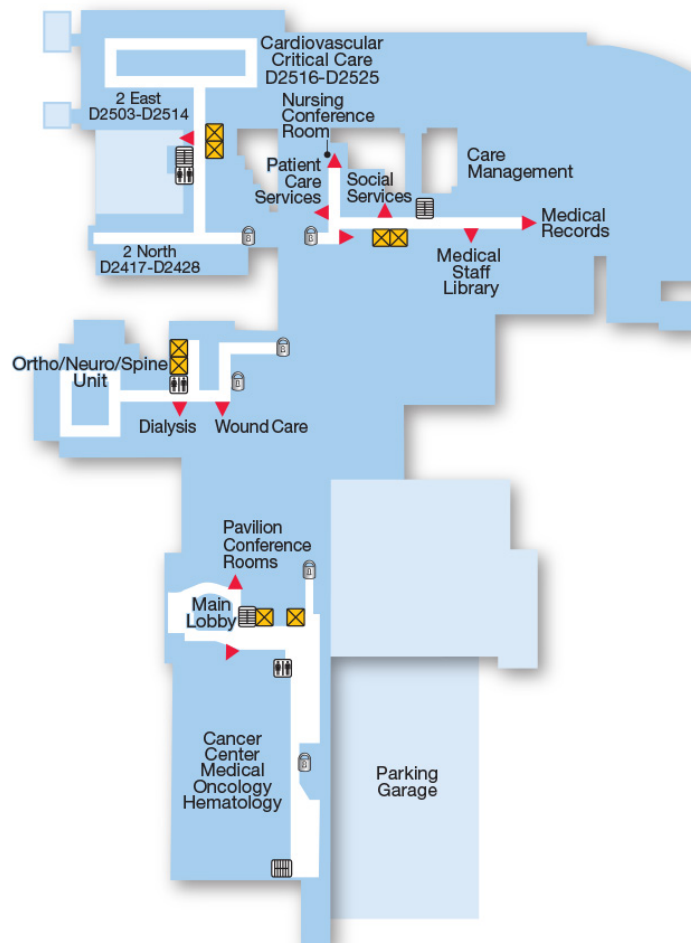

# Third Floor



## 3rd FLOOR

### Legend

- ▶ Entrance
- ⊠ Elevators
- ☐ Stairs
- ⏴ Waiting Area
- 🔒 Restricted Access
- ♿ Restrooms

 Smoking is not permitted on Bayhealth grounds.

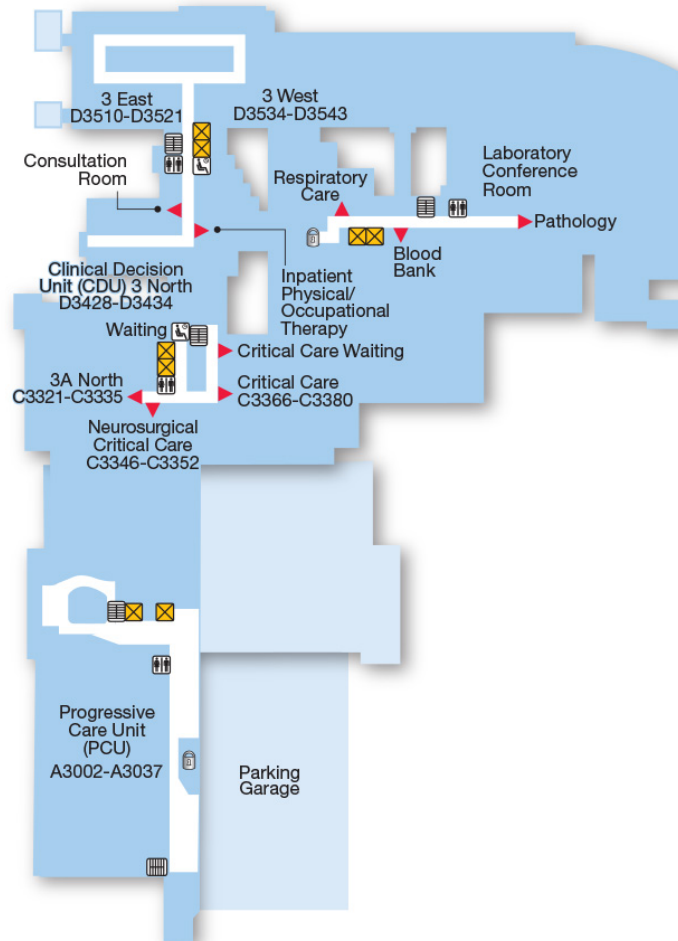





# Fourth Floor



 Smoking is not permitted on Bayhealth grounds.

## 4th FLOOR

- Legend**
-  Entrance
  -  Elevators
  -  Stairs
  -  Waiting Area
  -  Restrooms

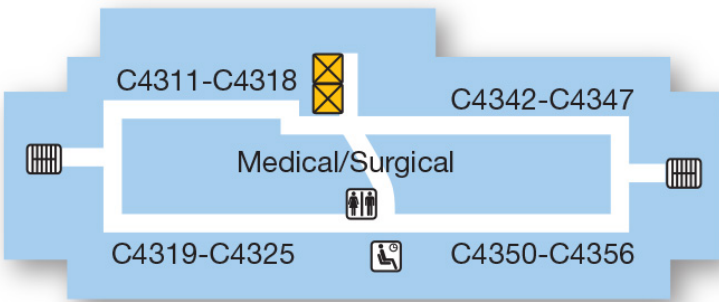

# Fifth Floor







 Smoking is not permitted on Bayhealth grounds.

## 5th FLOOR

### Center for Women & Infants

#### Legend

-  Entrance
-  Elevators
-  Stairs
-  Nurses Station

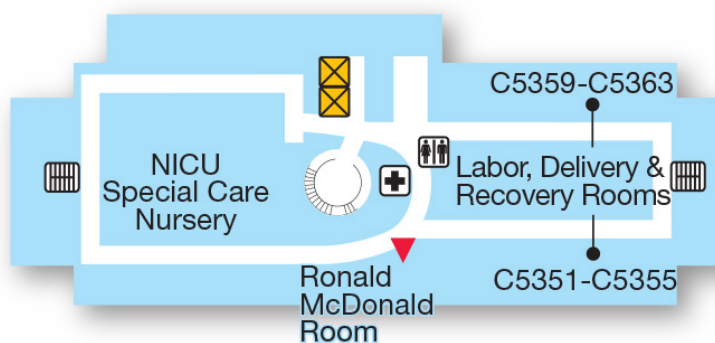

Produced by MedMaps® [www.medmaps.com](http://www.medmaps.com) © 2019 JDLA, LLC

# Sixth Floor







 Smoking is not permitted on Bayhealth grounds.

## 6th FLOOR

### Center for Women & Infants

Legend

-  Entrance
-  Elevators
-  Stairs
-  Nurses Station

