

Main Hospital

First Floor

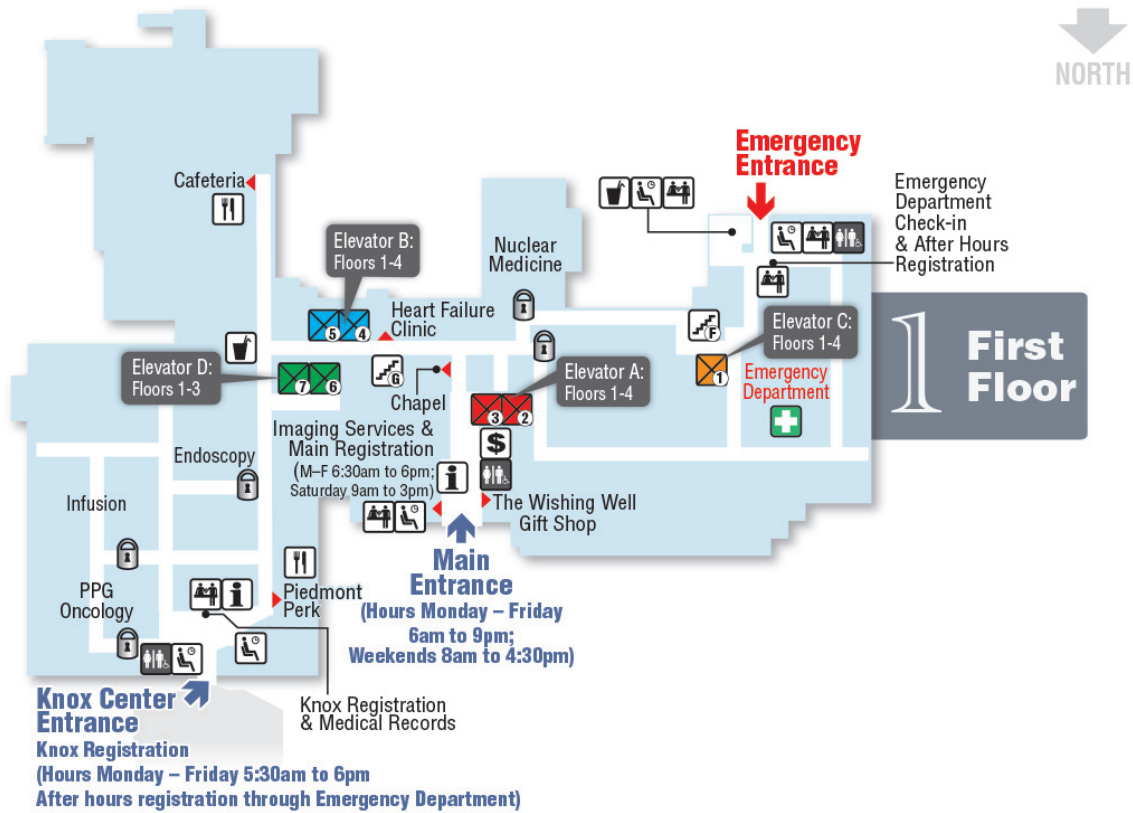

Legend

Public Elevator	Stairs	Restrooms	Caregiver Station	Waiting Area/Reception	Vending	Elevator A	Elevator C
Staff Elevator	Check-in/Registration	Wheelchair Accessible	Limited Access	Information	Dining	Elevator B	Elevator D

Produced by MedMaps® www.medmaps.com © 2026 JDLA, LLC

Second Floor

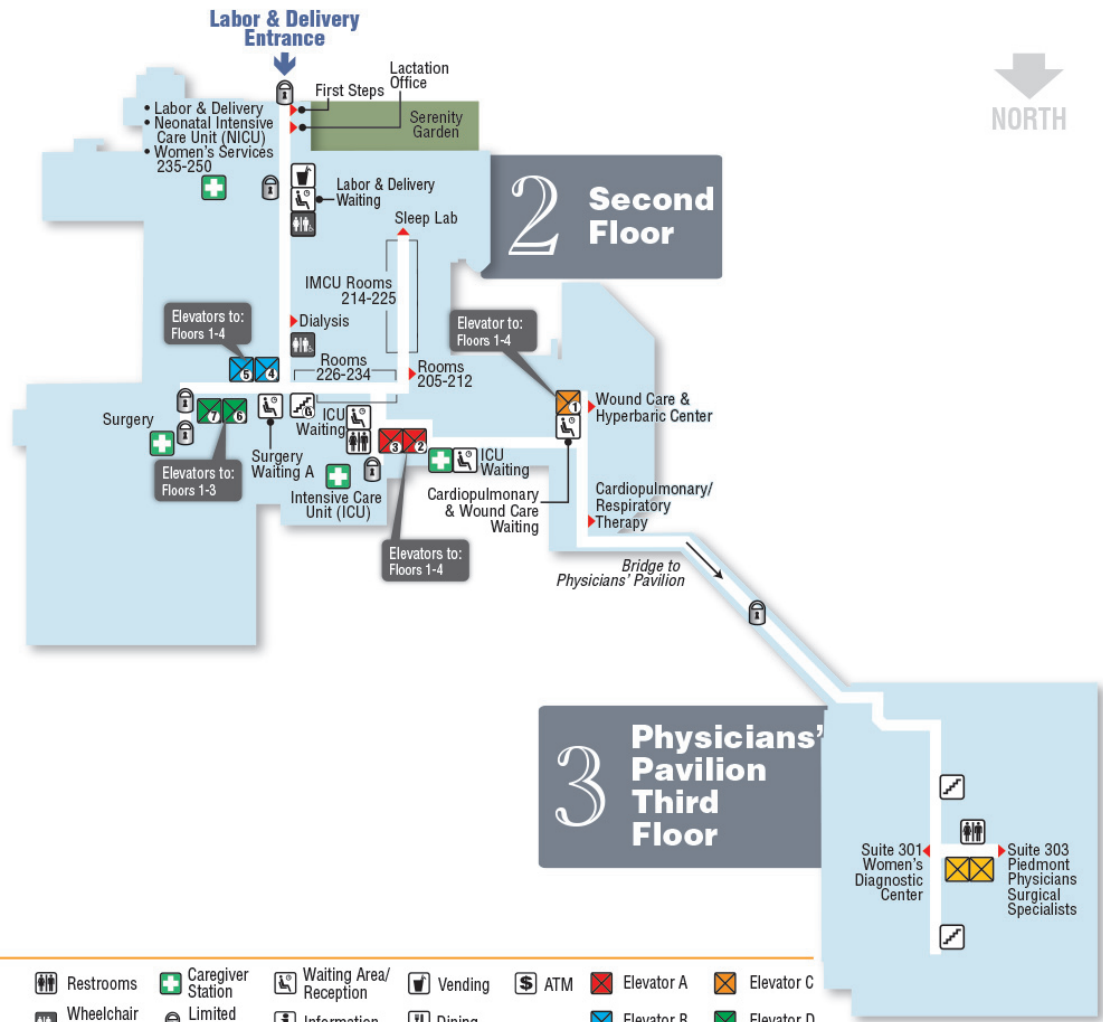

Third Floor

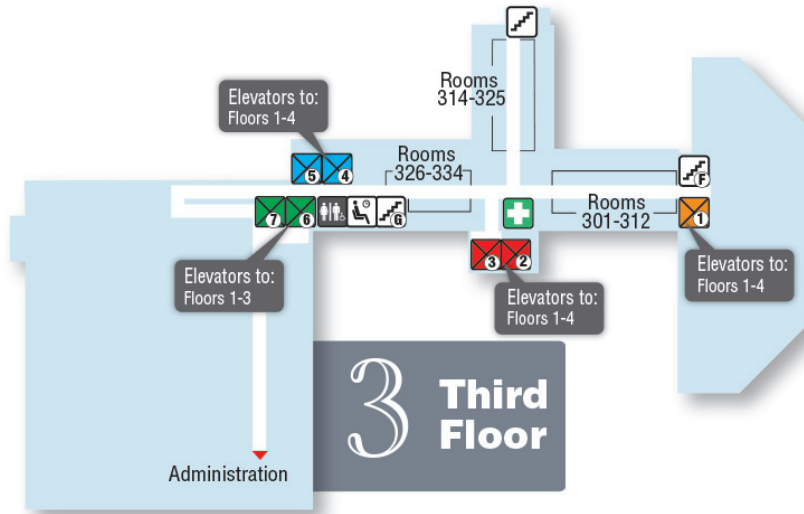

Legend

- | | | | | |
|--|--|--|--|--|
| | | | | |
| | | | | |

Produced by MedMaps® www.medmaps.com © 2026 JDLA, LLC

Fourth Floor

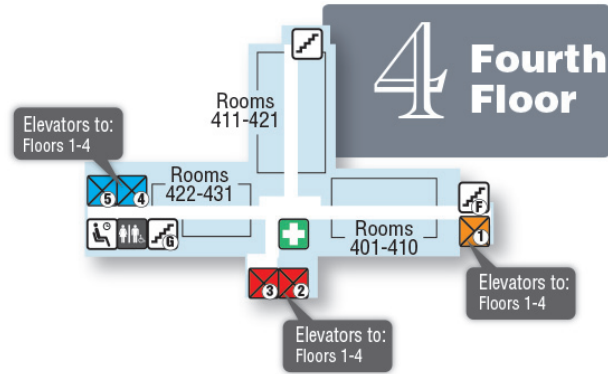

Legend

Public Elevator	Stairs	Restrooms	Waiting Area/ Reception	Elevator A	Elevator C
Staff Elevator	Wheelchair Accessible	Caregiver Station	Elevator B	Elevator D	

Produced by MedMaps® www.medmaps.com © 2026 JDILA, LLC