

Building 170

Ground Floor

Eugene J. Towbin Healthcare Center
Ground Floor Building 170



Legend	
	Elevators
	Vending
	Stairs
	ATM
	Waiting Room
	Restricted Access
	Information Desk
	Courtyard
	Cafeteria
	Restrooms

First Floor

Eugene J. Towbin Healthcare Center

First Floor Building 170

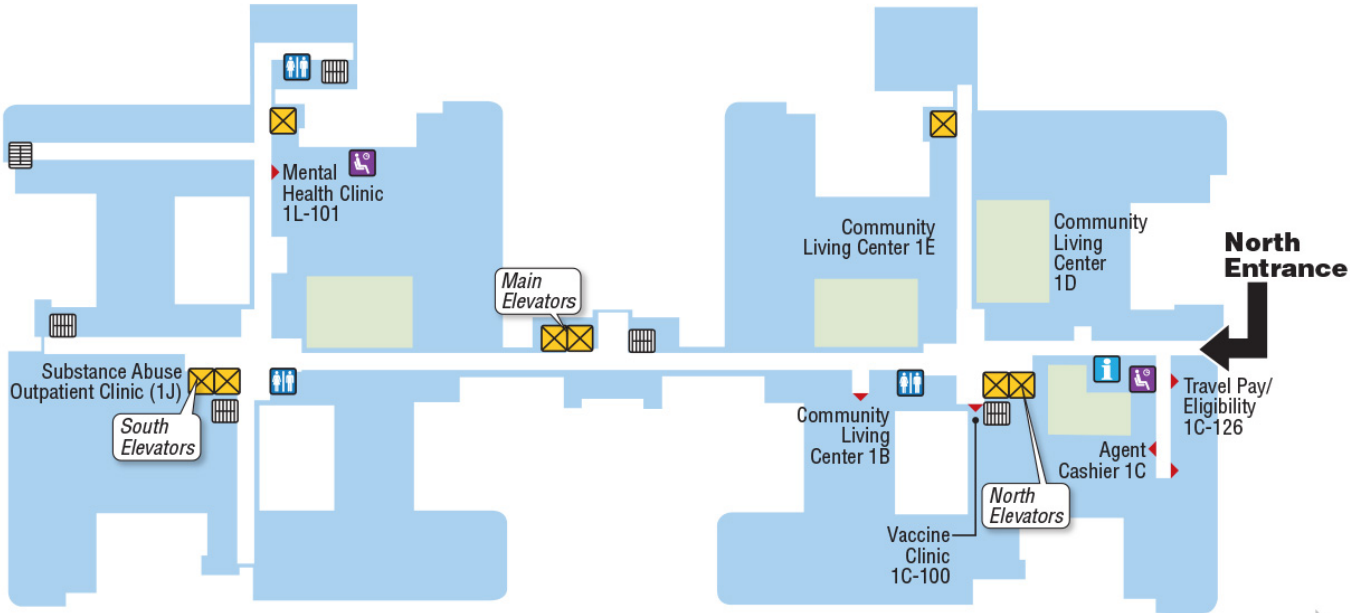

Legend	
	Elevators
	Stairs
	Waiting Room
	Information Desk
	Restrooms

Second Floor

Eugene J. Towbin Healthcare Center

Second Floor Building 170

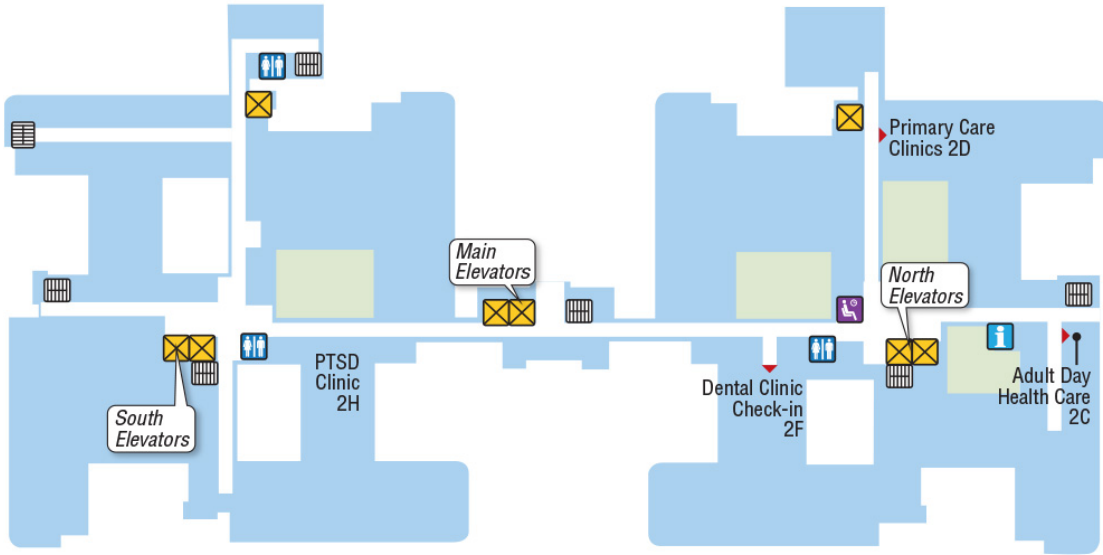

Legend	
	Elevators
	Stairs
	Waiting Room
	Information Desk
	Restrooms

Third Floor

Eugene J. Towbin Healthcare Center
Third Floor Building 170

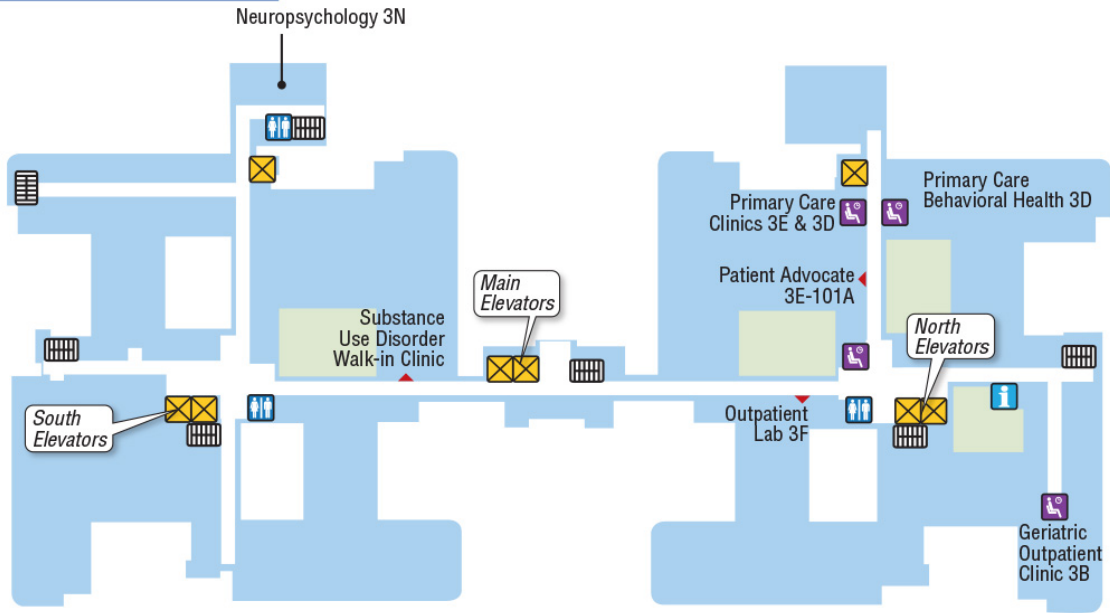

Legend

- Elevators
- Stairs
- Waiting Room
- Information Desk
- Restrooms

66 Ground

Eugene J. Towbin Healthcare Center

Ground Floor Building 66

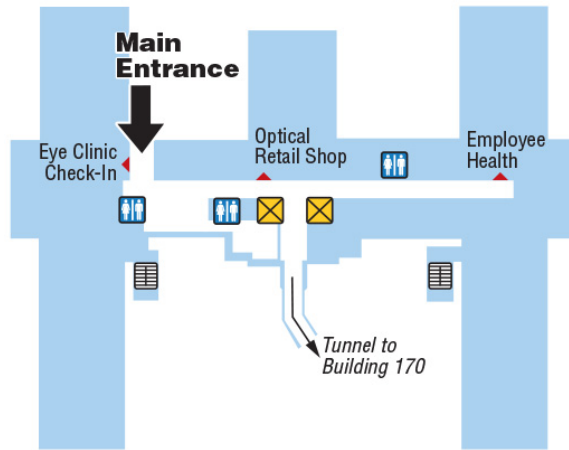

Legend	
	Elevators
	Stairs
	Restrooms

66 First Floor

Eugene J. Towbin Healthcare Center

First Floor Building 66

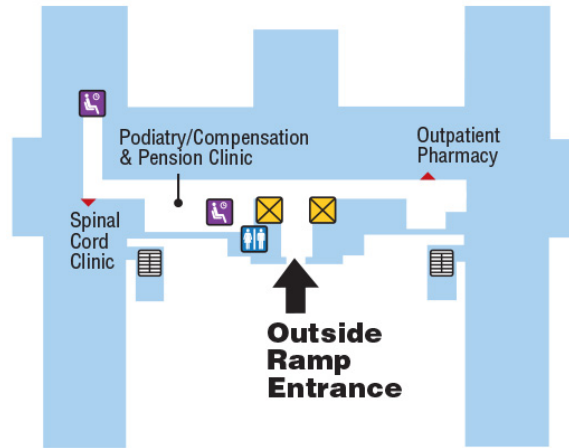

Legend

-  Elevators
-  Stairs
-  Restrooms

66 Second Floor

Eugene J. Towbin Healthcare Center

Second Floor Building 66

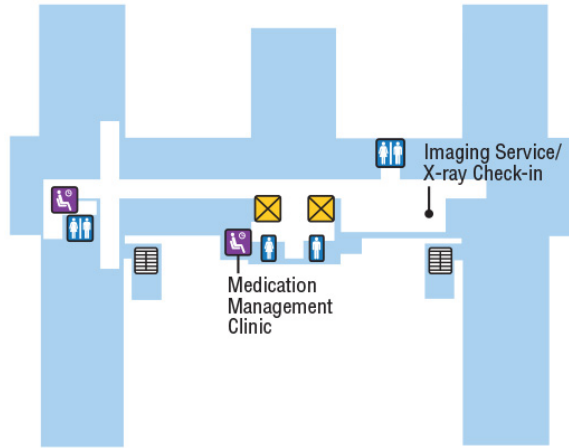

Legend	
	Elevators
	Stairs
	Restrooms